



[Home](#)

[Contact](#)

[Info](#)

[Map](#)

[Search](#)

West Virginia Development Office

Millsite Engineering Co., Inc. Building



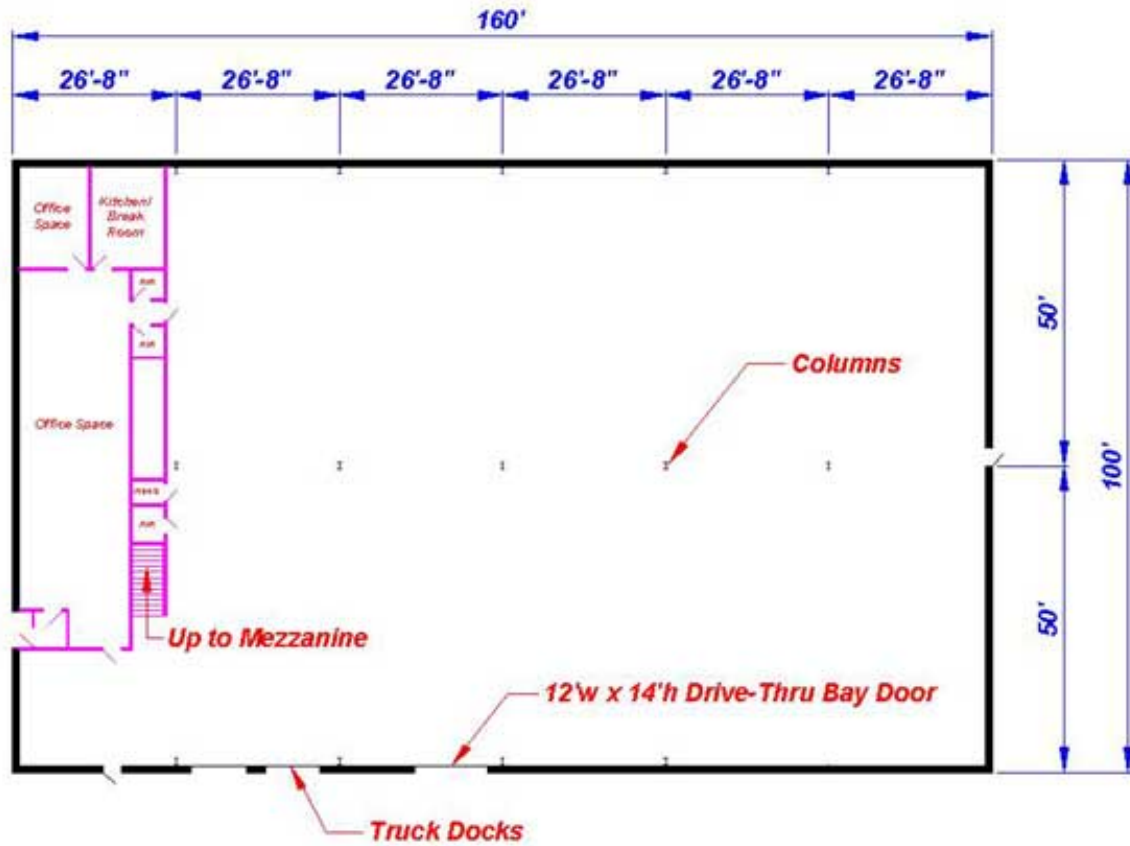

Location

City :	Millwood
County :	Jackson
Miles To Nearest Interstate Or 4 Lane Highway:	8.5
Miles To Nearest Commercial Airport:	45.0
Rail Access :	CSX
Navigable Waterways:	Ohio River

Size and Utilities

Total Sq. Ft. :	16000
Avail Sq. Ft. :	16000
Avail Acreage :	2.0
Electric :	Appalachian Power Company
Water :	Cottageville PSD
Gas :	None, but available through Mountaineer Gas Company
Sewer :	Cottageville PSD

Contact Information

Name :	Mark Whitley, Executive Director
Company :	Jackson County Development Authority
Address :	104 Miller Drive Ripley, WV 25271
Phone :	(304) 372-1151
Fax :	(304) 372-1153
Email :	info@jcda.org

[BACK](#)

Capitol Complex, Bldg. 6, Rm. 553 1900 Kanawha Blvd. E, Charleston, WV 25305-0311
Tel: 800.982.3386 304.558.2234 Fax: 304.558.0449

[Welcome to WV](#) | [Business Assistance](#) | [Real Estate](#) | [Small Business](#) | [International](#) | [Workforce Development](#)
[Community Matters](#) | [Media Center](#) | [Tourism Development](#) | [Who We Are](#)